

Town of Pelham User Fees and Charges 2023



Overview

An experience at a summer camp or swim program,
a requirement to obtain duplicate billing information or
a new beginning obtaining a house permit,
all of these experiences and more are realized within
this guide.

User fees and charges are established to ensure that services specific to individuals are not subsidized by all ratepayers within the Town of Pelham

The Town of Pelham is proud to offer the experiences outlined in this guide at a minimal cost to the community members that require them.

The user fees and charges outlined in this document are regulated by By-law 4411 (2022).

Disclaimer

Where it is found that a fee in this schedule is different than an approved bylaw or policy, the latter shall prevail.

All fees and charges do not include applicable taxes. Where fees and charges are subject to taxes, they will be added at point of sale.

Contact

For more information about content found within this guide, please contact:



Index



Clerk's Department



Corporate Services



Fire & By-Law Services



Planning & Development Services



Recreation & Cultural



Public Works

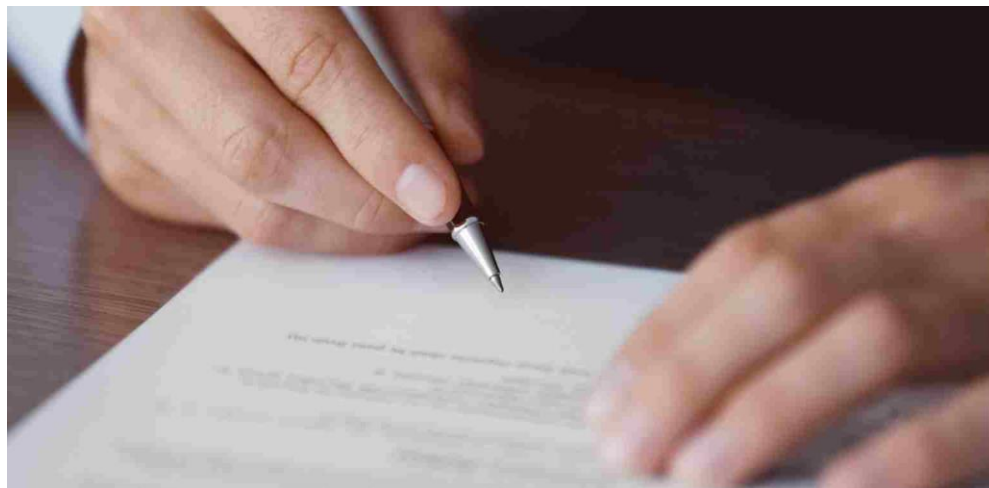

Clerk's Department

	2023
Business Licensing	
Itinerant Seller, Hawker, Peddler, Door to Door Seller	\$200.00
Refreshment Vehicle & Food Vending Vehicle	\$250.00
Bed and Breakfast, Fee Per Bedroom	\$150.00
Short Term Accommodation, Fee Per Bedroom	\$300.00
Affidavits/Commissioner of Oath	
Signature for all other documents – first document	\$15.00
Signature for all other documents – each additional document	\$5.00
Registrar statement/Travel letter – first letter	\$20.00
Registrar statement/Travel letter – each additional letter	\$5.00
Burial Permits/Death Registrations	\$10.00
Burial Permits/Death Registrations – After hours	\$100.00
Photocopies per page	\$0.25
Retrieval of Archived Records from Off-Site Storage	\$11.00
Lottery Licensing	
Bingo License % of prizes not exceeding \$5,500.00	3%
Raffle Lotteries % of prizes not exceeding \$50,000.00	3%
Bazaar Lotteries % of prizes not exceeding \$500.00	3%
Bazaar Lotteries – per wheel	\$10.00
Break Open Ticket (Nevada) Lottery % of prizes each occasion	3%
Break Open Ticket (Nevada) Lottery Home Base % of total	2.25%
Line Fences Administrative Fee	\$425.00



Clerk's Department

	2023
Marriage Licensing	
License Fee	\$130.00
Ceremony Fee – On Site – Business Hours* - \$50 Deposit Required Upon Booking, non-refundable if cancelled by wedding couple	\$200.00
During COVID-19, Outdoor Weddings at Peace Park are preferred. Rental of Peace Park Bandshell applies (10 people) p/hr, OR:	\$14.00
*Rental Fee – Business Hours – MCC Accursi Lounge (25 people) p/hr	\$23.00
*Rental Fee – Business Hours – MCC ½ Accursi (50 people) p/hr	\$35.00 \$51.00
Ceremony Fee – Off Site and After Hours (Plus Expenses)	\$300.00
Rehearsal Fee	\$75.00
Witness Fee – Municipal Staff – Normal Business Hours – Each	\$25.00
Cleaning Fees, if required	\$100.00
Municipal Property Damage – Billable	Full Cost Recovery
*Note 1: For the duration of the COVID-19 Pandemic, Council Chambers is not available for civil marriage ceremonies. All indoor Weddings must be at MCC with limited attendance, subject to Provincial guidelines which may change from time to time. Minimal rental fees apply and are subject to HST.	
Freedom of Information	
Application Fee	\$5.00
Photocopies – per page	\$0.20
Manual search, each 15 minutes	\$7.50
Preparation of record for disclosure – each 15 minutes	\$7.50
Retrieval of Archived Records in Off-Site Storage	\$12.50



Clerk's Department

	2023
Integrity Commissioner Complaint Filing Fee(s) *Per Term of Council*	
First Complaint	No Fee
Second Complaint	\$100.00
Three or More Complaints	\$300.00
*Please contact the Clerks Department for applicable exemptions	



Corporate Services

	2023
General Tax Services Fees	
Statement of Tax Account	\$10.00
Reprint of Tax Bill	\$10.00
Tax Certificate – Mailed	\$50.00
Tax Certificate – Verbal	\$25.00
Interest and Penalty on Tax Arrears	1.25%
NSF Charge	\$30.00
New Roll Creation	\$40.00
Ownership Change	\$40.00
Mortgage Company Administration Fee	\$15.00
Tax Registration Fees	
Tax Registration	Actual fees charged plus 25%
After Final Notice	Actual fees charged plus 25%
Sale by Tender/Auction	\$2,200.00
Preparation of Extension Agreement	\$500.00
POA add to taxes	\$50.00
General Accounts Receivable	
Interest on Accounts Receivable	1.25%
NSF Charge on Accounts Receivable	\$30.00
Administrative Fee for Adding Arrears to Tax	\$25.00



Fire & By-Law Services

	2023
Prevention, Protection and Inspection Fees	
File Search	\$75.00
Request for Reports/Copies	\$75.00
Photographs	\$10.00
Fireworks Permits	
Sales	\$100.00
Storage	\$100.00
Display	\$100.00
Fire Route Application	
Administration Fee	\$100.00
Residential Requests	
Mortgage Clearance	\$100.00
Change of Ownership	\$100.00
Multi residential after two units (each)	\$25.00
Burn Permit (annual)	\$25.00
Burn Permit (new requiring an inspection)	\$50.00
Commercial & Industrial Requests	
First 2000 square meters	\$200.00
Each additional 100 square meters (each)	\$50.00
Tenant Space Individual (each)	\$50.00



Fire & By-Law Services

	2023
Prevention, Protection and Inspection Fees (continued)	
L.L.B.O. Licenses Requests	
Premises	\$100.00
Patio (each)	\$50.00
Special Occasions (each)	\$50.00
Hotels-Motels Requests	
1-10 units	\$200.00
Over 10 units (per unit)	\$10.00
Day Care Requests	
Day Nurseries/Home Day Care Licenses	\$150.00
Fire Safety Plans	
Approvals	\$50.00
Inspection for Trade Shows	
Home Shows/Special Functions	\$150.00
Installation of Rural 911 Sign	\$100.00
Issuance of Occupant	
Loads sign – 60 persons or less	\$50.00
Loads sign – 61 persons or more	\$100.00
Vacation Rental Inspection Fee	\$150.00



Fire & By-Law Services

		2023
Prevention, Protection and Inspection Fees (continued)		
Accreditation Inspections		
Nursing Homes		\$150.00
Rest Homes		\$150.00
Seniors Apartments		\$150.00
Care Facilities		\$150.00
Fire Drills		
Fire drill observation by (an) inspector(s) assigned by the chief fire official of any subsequent fire drill within the same calendar year		\$500.00
Municipal Property Damage		Full Cost Recovery
Discretionary Fees		
Equipment, Labour and/or Materials used at an incident		Full Cost Recovery
False Alarm Response		
Per hour per Fire Department Vehicle		\$510.00
Per additional ½ hour per Fire Department Vehicle		\$255.00
<i>Note: False Alarm Fees will only be implemented when it is determined by the Fire Chief that the false alarm was preventable or the fire alarm system was improperly installed, maintained or resulted from a malicious act by an individual. See By-Law 3085(2010) for details.</i>		
Response to an unauthorized Open Air Burn		
Per hour per Fire Department Vehicle		\$510.00
Per additional ½ hour per Fire Department Vehicle		\$255.00



Fire & By-Law Services

2023

Municipal Property Damage (continued)

Motor Vehicle Fires and Collisions – Non Resident

Per hour per Fire Department Vehicle	\$510.00
Per additional ½ hour per Fire Department Vehicle	\$255.00

Fail to Comply with an Ontario Regulation causing an Emergency Response OR 210/01

Per hour per Fire Department Vehicle	\$510.00
Per additional ½ hour per Fire Department Vehicle	\$255.00

Note: Motor Vehicle fires and Collisions – Non Resident MAY be charged where the Pelham Fire Department has responded to an emergency situation, including motor vehicle accidents and fire, in which a non-resident person is involved.

Sign Fees

Ground Signs up to 50 square feet	\$100.00
Ground Signs over 50 square feet	\$150.00
Portable Ground Signs (1-60 days)	\$100.00
Pole Signs	\$150.00
Roof Signs	\$150.00
Wall Signs	\$100.00
Temporary Special Event Signs	\$100.00
Projecting Signs	\$150.00

Applications and Permits for Signs requiring Council Approval

Applications to Council for variance	\$250.00
--------------------------------------	----------



Fire & By-Law Services

	2023
Property Standards & Clean Yard (default not remedied)	
Administrative Fee	\$175.00
Initial Inspection Fee	\$95.00
Re-Inspection Fee	\$95.00
Mailing Fee	\$25.00
Fencing	
Application to Council for Fencing Variance	\$150.00
Kennel License	\$100.00



Planning & Development Services

	2023
Planning Fees	
Draft Plan of Subdivision	\$9,623.00
Resubmission of Draft Plan Prior to Approval	\$1,137.00
Modification to Draft Plan of Subdivision	\$6,014.00
Extension to Approval of a Draft Plan of Subdivision	\$963.00
Final Approval of a Draft Plan of Subdivision	\$1,806.00
Subdivision Agreement	*
Amendment to a Subdivision Agreement	\$904.00
Draft Plan of Condominium	\$4,813.00
Resubmission of Draft Plan of Condominium Prior to Approval	\$1,137.00
Modification to Approval of a Draft Plan of Condominium	\$2,407.00
Extension to Approval of a Draft Plan of Condominium	\$963.00
Town Consultant Review Fee	Full Cost Recovery
Condominium Agreement	*
Amendment to Condominium Agreement	\$904.00
Development Agreement Application	*or**
Town Consultant Review	Full Cost Recovery
Amendment to Development Agreement	\$904.00
Release of Development Agreement	\$1,085.00
Site Plan Approval Application **Note: separate fee for the agreement	\$4,210.00
Resubmission of Site Plan Prior to Approval	\$853.00
Site Plan Approval for Minor Development i.e. farm help house, triplex, building addition <100m ² etc.	\$1,193.00
Town Consultant Review Fee	Full Cost Recovery



Planning & Development Services

	2023
Site Plan Amendment ***Note: Separate fee for the agreement	\$3,010.00
Release of Site Plan Agreement	\$1,085.00
*Subdivision Agreements, Site Plan Agreements and Development Agreements requiring the extension of municipal services	
Garden Suite Agreement	\$1,739.00
Encroachment Agreement	\$335.00
Zoning By-Law Amendment	\$4,813.00
APO Zoning By-Law Amendment	\$3,010.00
Official Plan Amendment	\$6,014.00
Combined Zoning By-Law & Official Plan Amendment	\$9,623.00
Extension of a Temporary Use By-Law	\$3,010.00
Removal of Holding Symbol	\$602.00
Town Consultant Review Fee	Full Cost
Repeal of Interim Control By-Law	\$1,202.00
Deeming By-Law	\$602.00
Lifting of Inhibiting Order	\$602.00
Lifting of One Foot Reserve	\$602.00
Removal of Part Lot Control	\$1,202.00
Communication Towers and Renewable Energy Application	\$1,202.00
Property Standards Appeal	\$602.00
Aggregate Application Fees	Full Cost
Real Estate Compliance Letter (10 business day service)	\$146.00
Real Estate Compliance Letter (Expedited 4 business day service)	\$234.00
Zoning Information Letter (10 business day service)	\$109.00

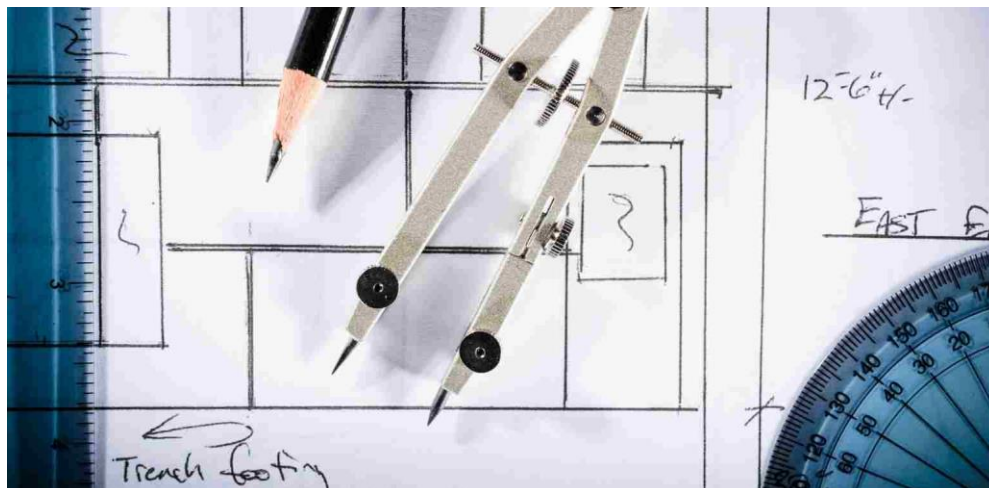

Planning & Development Services

2023

Planning Fees (continued)

* Subdivision Agreements, Site Plan Agreements and Development Agreements requiring the extension of municipal services

\$11,562.00 where the cost of construction of all Work is less than \$100,000.00;

\$11,562.00 plus 4.0% of the costs between \$100,000.00 and \$400,000.00;

\$25,113.00 plus three and one-half percent (3.5%) of the costs exceeding four hundred thousand dollars (\$400,000.00);

** Site Plan Agreements; and, Development Agreements where municipal services are not required to be extended **\$2,893.00**

*** Shall be paid in addition to the Official Plan Amendment, Zoning By-Law Amendment and other planning application fees

Agreements for temporary Second Dwelling Units	\$1,114.00
Change of Address	\$128.00
Consent	\$1,607.00
Request for Change in Conditions	\$590.00
Rescheduling Fee	\$269.00
Final Certification	\$423.00
Recirculation Due to Change in Application	\$269.00
Special Hearing Fee (In Addition to Application Fee)	\$590.00
Minor Variance	\$1,178.00
Rescheduling Fee	\$269.00
Recirculation Due to Change in Application	\$269.00
Special Hearing Fee (In Addition to Application Fee)	\$590.00
Cancel Consent Application Fee	\$412.00
Cancel Consent Certificate Fee	\$103.00



Planning & Development Services

	2023
Building Permit Fees	
Minimum Permit Fee unless otherwise stated	\$279.00
<i>New Construction – per square foot</i>	
Assembly Occupancies – Group A	
School, church, restaurant, theatre, educational or recreational facility and similar occupancies	\$1.92
Preparation of record for disclosure – each 15 minutes	\$8.06
Institutional Occupancies – Group B	
Hospital, nursing home, reformatory, prison and similar occupancies	\$1.92
Residential Occupancies – Group C	
Single Family Dwelling, Semi-Detached Dwelling & Duplex Dwelling	\$1.58
Multiple Unit Dwelling i.e. apartment dwelling, townhouse dwelling, hotels, motels, other residential buildings or parts thereof	\$1.62
Residential Additions	\$1.40
Business/Personal Services Occupancies – Group D	
Office, bank, medical office/clinic and similar occupancies	\$1.92
Mercantile Occupancies – Group E	
Store, Shopping mall/plaza, shop, market, retail outlet and similar	\$1.92
Industrial Occupancies – Group F	
Industrial mall, plaza, garage, plant, factory, warehouse, manufacturing building and similar occupancies	\$1.79
Special Occupancies/Categories	
New Farm Buildings	\$0.55
Tents	\$279.00



Planning & Development Services

	2023
Special Occupancies/Categories per square foot (continued)	
Park Model Trailer, Mobile Home	\$279.00
Accessory Buildings/Structures	
Garage/Carport, Deck/Porch/Patio, Sunroom/Solarium, shed or other accessory building	\$279.00 \$.094> 300/ft ²
Private Swimming Pool	\$279.00
Public Swimming Pool or Spa	\$836.00
Designated Buildings/Structures	
Communication Tower, Solar Panels, Retaining Wall, Pedestrian Bridge, Wind Turbine, Crane Runway and similar buildings/structures	\$557.00
Alterations & Repairs – per square foot	
Interior Alterations/Repairs/Tenant Improvements	
Assembly occupancies – Group A	\$0.44
Institutional Occupancies – Group B	\$0.44
Residential Occupancies - Group C	\$0.34
Business/Personal Service - Group D	\$0.44
Mercantile Occupancies - Group E	\$0.44
Industrial Occupancies - Group F	\$0.44
Alterations/Additions to existing Farm Buildings	\$0.30
Alter/Replace Roof Structure	\$0.44
Fireplace, Woodstove, Insert, Chimney and similar construction	\$279.00



Planning & Development Services

	2023
<i>Demolition</i>	
Part 9 Buildings/Structures	\$279.00
Other	\$836.00
<i>Miscellaneous</i>	
Partial Occupancy (does not apply to single family dwellings)	\$279.00
Change of use of a building or part thereof	\$279.00
Transfer of a Permit to a New Owner	\$279.00
Request for Deferral of Permit Revocation	\$279.00
Move a Building/Structure	\$279.00
Conditional Permit	\$668.00
Conditional Permit Agreement	\$279.00
Permit Renewal / Per Year	\$122.00
Re-inspection Fee	\$84.00
Clearance Letter	\$84.00
Building Code Order Compliance Letter	\$168.00
Hourly Rate	\$72.00
Occupant Load Inspection	\$279.00
Photocopying & printing per page	\$0.28
Alternative Solution Review	\$557.00
<i>Partial Permit/Staged Construction</i>	
Building Foundation	15%
Building Shell	75%
Building Completion	10%



Planning & Development Services

2023

Plumbing

For plumbing work not included in any of the above classes of permit

First 6 fixtures	\$279.00
Each additional	\$11.15

Refund of Permit Fees

Where only administrative functions have been completed (application received and cost analysis complete)	90%
Where only administrative and zoning functions have been completed	80%
Where administrative, zoning and plans examination functions have been performed	60%
Where the permit has been issued and no inspections performed	50%
Deduction for each inspection performed	5%
No fees shall be refunded after twelve (12) months from the date of permit issuance or when refund is less than \$100	

Construction Prior to Permit Issuance

Where construction has commenced prior to the issuance of a permit for any class of permit described herein, the permit fee shall be **doubled**

Municipal Property Damage

Full Cost Recovery



Recreation & Cultural Services

2022	
Arena Rentals	
Ice Time – per hour (50min)	
Prime Time - Weekdays 4pm – midnight & weekends	\$215.00
Prime Time - Youth	\$154.00
Non-Prime Time – Weekdays prior to 4pm	Youth \$91.00 / Adult
Prime Time Last Minute Ice (less than 24hrs notice)	Youth \$75.00 / \$118.00
Trainers Rate – 5 max	\$62.00
Summer Ice (April 15 – August 15)	
Non-Prime Time	\$118.00
Prime Time - Youth	\$154.00
Prime Time - Adult	\$182.00
Corporate Sponsor Free Skate Rates	
Prime Time Friday Skate Sponsorship per occurrence	\$270.00
Prime Time Sunday Skate Sponsorship per occurrence	\$315.00
Non-Prime Public Skate Sponsorship per occurrence	\$154.00
Public Skating	
Adults	\$3.54
Students/Seniors	\$3.10
Child	\$3.10
Family (up to 5 members)	\$10.62
Preschool Skate	\$3.10
Non Profit Organized Group Rate	\$26.55
Children's Birthday Party (Under 14 yrs., Max 15 children)	
• 2 hour hall + public skate or 1 hour gym	\$118.00
• + theme party (decorations)	N/A
• + specialty party (staff led options – tea party/craft/gym activities)	N/A

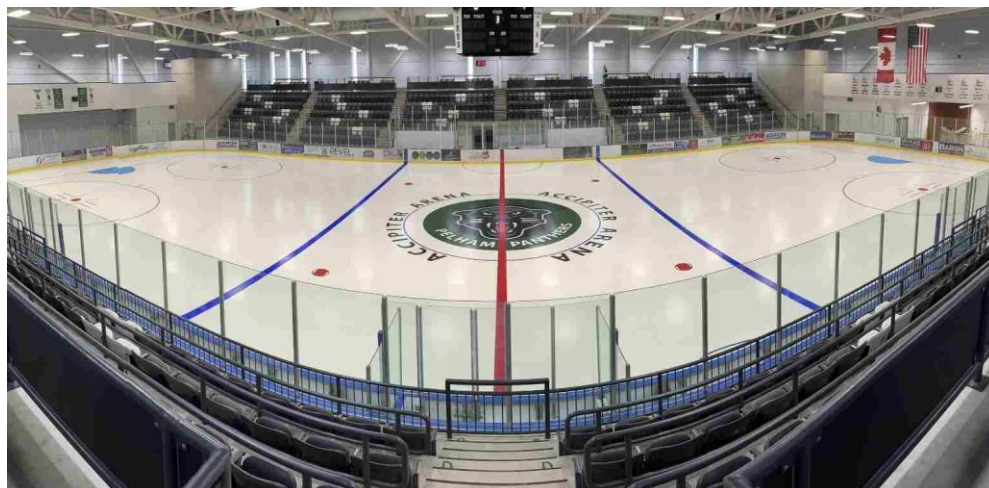

Recreation & Cultural Services

Arena Rentals (continued)		2023
Photo booth with props (no camera)		\$18.50
Special Skating		
Shinny Hockey Drop-In		\$5.31
Women's Hockey – Learn To Play Drop-In		\$5.31
Women's Hockey – Learn To Play Program + Shinny Combo		\$8.85
Adult Learn To Skate (10 classes)		\$61.95
Ticket Ice		\$5.31
Summer Floor Rates – hourly		
Hourly - Adult		\$56.00
Hourly – Youth		\$37.00
Daily Event		\$546.00
Daily - Youth		\$357.00
Event Electrical System Includes ESA inspection		\$1,150.00
MCC Arena Advertising		
Accipiter Arena		
On Ice (Per Ice Season/Year)		N/A
Boards (Per Year)		\$1,000.00
Duliban Insurance Arena		
On Ice (Per Ice Season/Year)		\$750.00
Boards (Per Year)		\$800.00



Recreation & Cultural Services

Rentals (continued)		2023
Ice Resurfacer (Per Side/Year)		\$2,000.00
Old Pelham Town Hall		
Monday – Thursday (Daily Rental)		\$138.00
Monday – Thursday (Hourly Rental)		\$35.00
Friday – Sunday & Holidays (Daily Rental)		\$247.00
Friday – Sunday & Holidays (Hourly Rental)		\$51.00
Youth/Multiple Use Rate (5+) (Daily Rental Monday to		\$110.00
West Lounge		\$37.00
Stage Rental per set up		\$225.00
Refundable Security Deposit (taxes not applicable)		\$100.00
SOCAN fee – without dancing per event		Full Cost Recovery
SOCAN fee – with dancing per event		Full Cost Recovery
Meridian Community Centre Gymnasiums		
½ gymnasium rental (hourly) Licensed Users-Youth Rate/Service Club		\$13.00
Full size gymnasium rental (hourly)		\$44.00
Full size gymnasium rental daily (Service Club)		\$260.00
½ gymnasium rental (hourly)		\$23.00
Custodial Charge (hourly)		\$39.00
Team Chairs (per event)		\$125.00
Set up & Use of Nets & Standards (Volleyball, Badminton, Pickleball)		\$10.00/per



Recreation & Cultural Services

Rentals (continued)		2023
Equipment Rental (Volleyball; Badminton Racquet w shuttle; Pickleball Racket w ball)		\$2.00 per
Gym Floor Covering (Per Gym)		\$250.00/event
Meridian Community Centre – Kinsmen Community Room		
FULL ROOM		
Daily – Monday to Thursday		\$138.00
Hourly – Monday to Thursday		\$35.00
Daily – Friday to Sunday & Holidays		\$246.00
Hourly – Friday to Sunday & Holidays		\$51.00
HALF ROOM		
Daily – Monday to Thursday		\$68.00
Hourly – Monday to Thursday		\$19.00
Daily – Friday to Sunday & Holidays		\$123.00
Hourly – Friday to Sunday & Holidays		\$27.00
Meridian Community Centre – Dr. Gary & Mall Accursi		
Multipurpose Community Room		
FULL ROOM		
Daily – Monday to Thursday		\$206.00
Hourly – Monday to Thursday		\$52.00
Daily – Friday to Sunday & Holidays		\$370.00
Hourly – Friday to Sunday & Holidays		\$76.00
HALF ROOM		
Daily – Monday to Thursday		\$137.00
Hourly – Monday to Thursday		\$35.00
Daily – Friday to Sunday & Holidays		\$246.00
Hourly – Friday to Sunday & Holidays		\$51.00

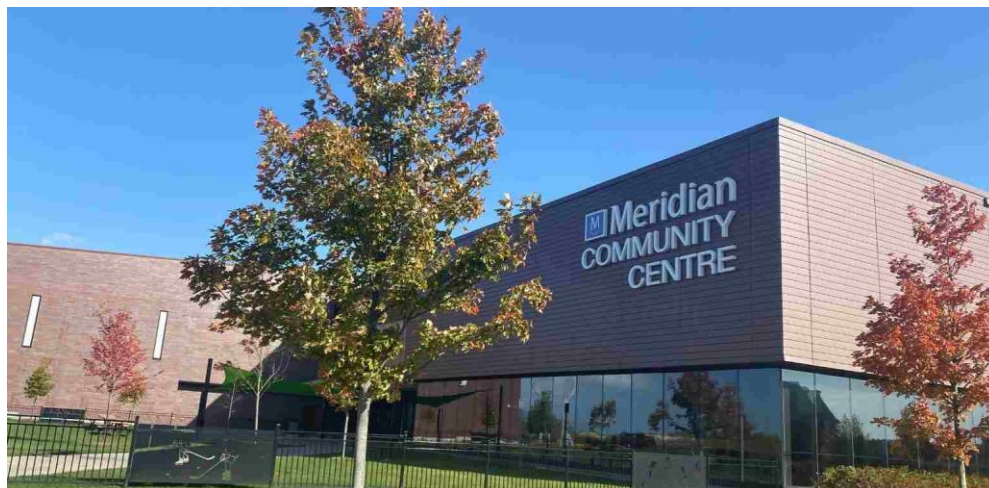

Recreation & Cultural Services

Rentals (continued)	2023
Special Functions Area	
Hourly	\$23.00
Daily	\$87.00
Daily (with rental of Dr. Gary Accursi Multipurpose Community	\$54.00
Community room – Kitchen	
Daily (with rental of Dr. Gary & Mall Accursi Multipurpose Community Room)	\$54.00
Atrium	
TOP Facility User Groups – 8' space 1 table + 2 chairs/day per	\$26.00
MCC Servery – Ciolfi's Corner	
Hourly	\$35.00
MCC – Small Meeting Room (RCW Meeting Room & Main Floor)	
Monday to Thursday (Daily)	\$52.00
Friday to Sunday & Holidays (Daily)	\$83.00
Monday to Thursday (Hourly)	\$12.00
Friday to Sunday & Holidays (Hourly)	\$18.00
Miscellaneous	
Refundable Security Deposit (taxes not applicable)	\$100.00
Last Minute Cancellation Fee (less than 24hrs) – Applicable to all	\$41.00
SOCAN fee - without dancing per event	Full Cost Recovery
SOCAN fee – with dancing per event	Full Cost Recovery
Stage Rental per set up	\$125.00
Pelham Minor Hockey Association Courtyard (Hourly/Daily)	\$30.00/\$125.00
Portable Bar per rental	\$125.00



Recreation & Cultural Services

Rentals (continued)	2023
Serving Fee per event	\$125.00
Linen Rental Fees	\$12.00/ item
Propane Heaters Rental Fee	\$30.00/heat
Summer Field Rate Schedule	
Ball Diamonds	
Level "A" groomed and lined	\$25.00
Level "A" youth	\$18.00
Level "C" no service	\$15.00
Level "C" youth	\$11.00
Diamond Lights (per hour)	\$13.00
Tournaments & Special Events	
Level "A" groomed and lined	\$198.00
Level "A" youth	\$141.00
Level "C" no service	\$119.00
Level "C" youth	\$85.00
<i>Note: Fees do not include use of lights – apply per hour light fee if required</i>	
Soccer Fields per hour	
Adult	\$24.00
Minor	\$19.00
Soccer Lights (per hour)	\$31.00
Soccer Tournament and Special Events	
Adult	\$189.00
Minor	\$147.00
Soccer Field Lining – Non Municipal Fields per facility per lining	\$200.00



Recreation & Cultural Services

	2023
Park Pavilions: Centennial Park & Harold Black Park and MSSP Park Pavillion	
Park Pavilion	\$36.00
Passive Areas: Centennial Park & Harold Black Park	
Permit Fee	\$31.00
Peace Park including Bandshell	
Pavilion Rate + Passive Area Rate (under 100 people)	\$69.00
Pavilion Rate + Passive Area Rate (over 100 people)	\$139.00
Per Hour Rate	\$16.00
SOCAN fee	Full Cost
Town Staff fee (per hour)	\$40.00
Hydro Fee for One Time Events	\$46.00
Centennial Park Tennis and Pickle Ball Courts	
Tennis lights per season	Full Cost
Family Membership	\$150.00
Single Adult Membership	\$100.00
Single Student/Senior Membership	\$50.00
Children (12 years and under)	Free
Outdoor Court Instructor Rental – per court per day up to 3 hrs per	\$20.00
Lesson Fees will be determined based on competitive rates	



Recreation & Cultural Services

	2023
Storage Space Per Year	
Youth Organization Storage	\$500.00
Centennial/ H.B. Park	\$50.00
Supply Rentals (Daily Fee with Facility Rental)	
Picnic Table/Folding Table	\$25.00
Folding Cruiser Table	\$12.00
10 x 10 Tents with Weights	\$28.00
Kids Folding Table	\$12.00
Refundable Equipment Deposit (taxes not applicable)	\$100.00
Aquatic Rates	
Swimming Lessons	
Parent & Tot 1, 2, 3	\$69.00
Preschool A-E	\$80.00
Swimmer 1, 2	\$80.00
Swimmer 3, 4, 5, 6	\$86.00
Patrol (Rookie, Ranger, Star)	\$89.00
Private Lessons (10)	\$190.00
Semi Private Lessons (10)	\$160.00
Stroke Builder Lessons (10)	\$86.00
Bronze Star	\$92.00
Bronze Medallion/Emergency First Aid CPR (Additional Fee for Materials)	\$163.00
Canadian Lifesaving Society Manual	Cost
Bronze Cross	\$138.00
Bronze Cross Recertification	\$56.00
Swim Team	\$115.00
NL Recertification	\$79.00
Facility Charges	
Pool Rental per hour (includes 2 lifeguards)	\$116.25



Recreation & Cultural Services

Aquatic Rates (Continued)		2023
Lifeguard Fee Per hour		\$30.00
Public Swim Rates		
Adult		\$3.98
Child/Senior		\$3.54
Family		\$11.95
Swim Pass – Single		\$55.75
Swim Pass - Family		\$101.77
Aqua Zumba		\$5.31
Lane Swim (1 lane for 1 hour/week for the season)		\$20.00
Camp Rates		
March Break Camp		
Single Week		\$190.00
Single Day Registration		\$65.00
Family Weekly Registration Discount Each Child after 2 nd Child		(\$45.00)
Extended Care per week		\$38.00
Extended Care per day		\$8.50
Lunch per week		\$48.50
Lunch per day		\$10.00
Leaders in Training Program		\$115.50
Refund Administration Fee		\$20.00
Summer Camp		
Single Day Registration		\$65.00
Single TRIP Day Registration		\$65.00
Single Week Registration		\$190.00

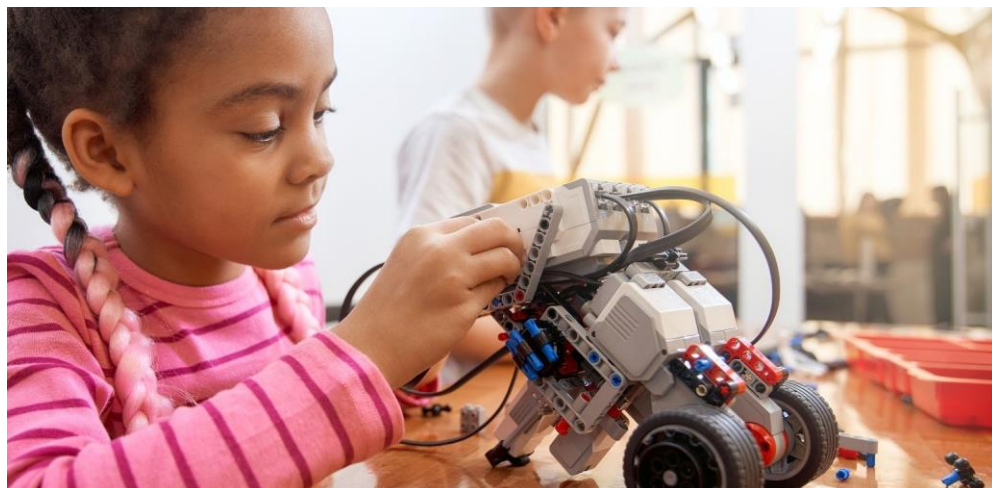

Recreation & Cultural Services

	2023
Multiple Week Registration discount each week after 2 weeks	(\$10.00)
Family Day Registration (max 3)	N/A
Family TRIP Day Registration (max 3)	N/A
Family Weekly Registration Discount Each Child after 2 nd Child	25%
Extended Care per week	\$38.00
Extended Care per day	\$8.50
Extended Care Multiple weeks (3 weeks or more)	\$33.00
4 Day Camp Week (Due to Holiday)	\$150.00
Refund Admin Fee – before June 1	\$20.00
Refund Admin Fee – After June 1 – 2 weeks prior to camp week	\$50.00
STEM Camp	
Single Week Registration (25% discount on three or more children)	\$299.00
Early Bird Registration Fee (25% discount on three or more children)	\$279.00
Multiple Week Registration Discount (each week after 2 weeks)	\$10.00
Extended Care per week	\$38.00
Optional Friday Lunch	\$10.00
Specialty Programs/Camps	
Single Week Registration	\$210.00
Family Weekly Registration Discount Each Child after 2 nd Child	25%
Extended Care per week	\$38.00
Extended Care per day	\$8.50
Extended Care Multiple weeks (3 weeks or more)	\$33.00
Ballroom Dance Lessons (10 Classes)	\$72.57
Ballroom Social Tickets	\$15.00
Improv Classes (10 Classes)	\$9.00



Recreation & Cultural Services

Specialty Programs/Camps (continued)	2023
Triathlon Club Monthly	\$65.00
Triathlon Club with Swim Team membership Summer	\$225.00
Activity Drop in Fee Adult	\$5.31
Activity Punch Pass (20) Adult	\$70.80
Activity Drop in Fee Youth	\$3.10
Activity Punch Pass (25) Youth	\$70.80
Seniors Social Membership Fee - Annual	\$36.00
P.D Camp Registration	\$65.00
Holiday Workshop Registration (includes dinner)	\$30.00
Mini Camp	\$120.00
Brock Fit (12 weeks)	\$119.47
Pickleball Clinics (Per Person)	\$14.00
Spin classes 10 week session/Drop In	\$100.00 /\$10
Municipal Property Damage	Full Cost
Pelham Transit (As Pilot Project, Operated by Regional Transit On Demand)	
Standard Bus Fare	N/A
Bus Ticket Pack (11 Tickets)	N/A
Bus Pass Monthly	N/A



Public Works

	2023		
Culvert Fees	3 meter	6 meter	9 meter
250 mm Culvert + Coupler \$11.00	\$820.00	\$1,229.00	\$1,843.00
300 mm Culvert + Coupler \$21.00	\$858.00	\$1,305.00	\$1,957.00
375 mm Culvert + Coupler \$29.00	\$897.00	\$1,381.00	\$2,071.00
450 mm Culvert + Coupler \$36.00	\$945.00	\$1,477.00	\$2,216.00
525 mm Culvert + Coupler \$74.00	\$1,012.00	\$1,611.00	\$2,415.00
600 mm Culvert + Coupler \$73.00	\$1,068.00	\$1,725.00	\$2,587.00

*** larger or off sizes will be charged as per occurrence

Cemeteries

Resident Rates

Land Acquisition

Adult Grave	\$670.00
Perpetual Care per lot	\$440.00
Columbarium niche	\$2,414.00
Perpetual Care per niche (15%)	\$426.00

Non-Resident Rates

Land Acquisition

Adult Grave	\$1,056.00
Perpetual Care per lot	\$704.00
Columbarium niche	\$3,009.00
Perpetual Care per niche (15%)	\$531.00

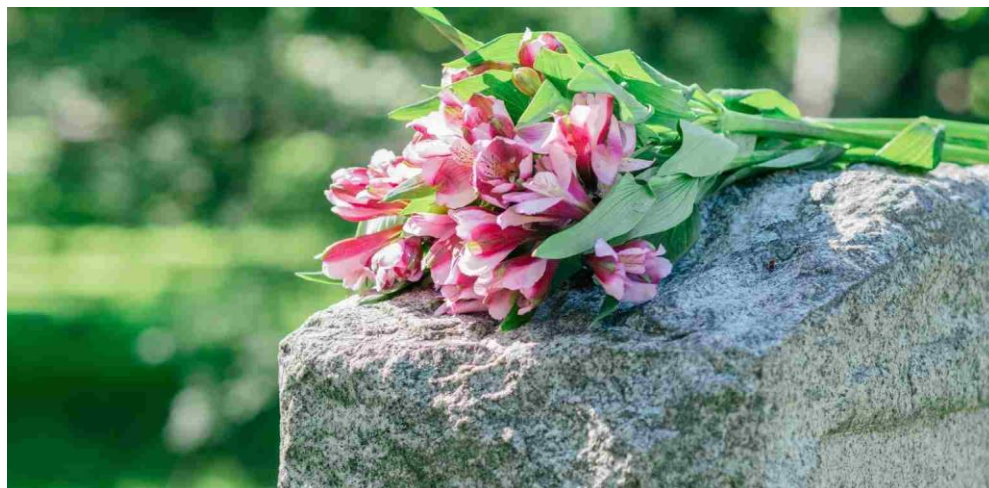

Public Works

	2023
Interment Fees (not including Administrative Fee)	
Standard Burial	
Adult	
Opening and Closing Weekdays	\$672.00
Opening and Closing Saturday morning	\$964.00
Opening and Closing Saturday afternoon	\$1,014.00
Infant	
Weekdays	\$316.00
Saturday	\$642.00
Cremated Remains	
Weekdays	\$249.00
Saturday	\$488.00
Columbarium Weekday	\$298.00
Columbarium Saturday	\$499.00
Mausoleum	
Weekdays	\$332.00
Saturday	\$498.00
Disinterment Charges	
Adult/Child disinterment only	\$1,018.00
Infant/Stillborn disinterment only	\$338.00

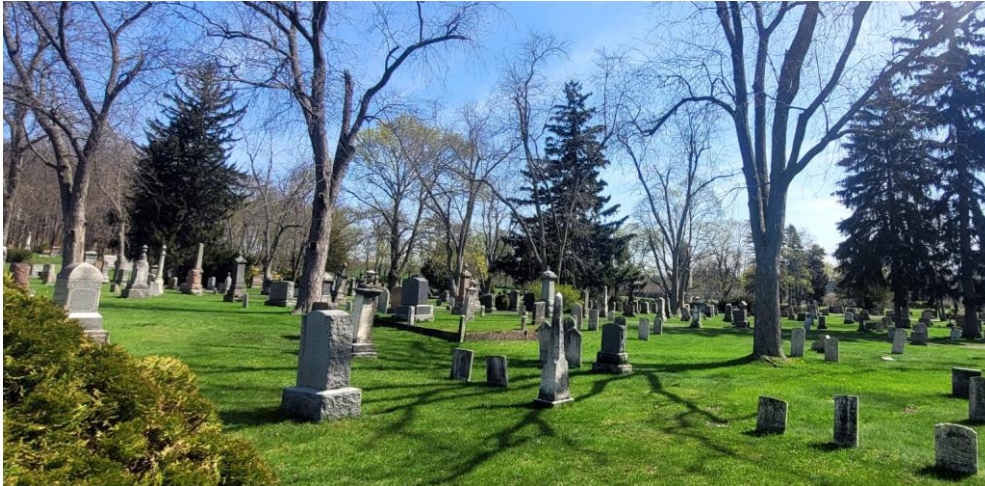

Public Works

	2023
Disinterment Fees (continued)	
Cremains disinterment only	\$736.00
Columbarium Removal only	\$298.00
Foundation Charges	
Foundation charge per cubic foot	\$45.00
Markers	\$98.00
Cornerstones	\$103.00
Administration Fees	
Interment Administrative Fee	\$13.00
Interment Rights Transfer	\$57.00
Interment Rights Exchange	\$57.00
Interment Rights Replacement/Duplicate	\$35.00
Cemetery Records Search – per hour	\$30.00
Marker Perpetual Care and Maintenance	
Upright marker four feet or less in height and length	\$200.00
Upright market more than four feet in height or length	\$400.00
Flat Marker over 173 square inches	\$100.00



Public Works

	2023
Foundation Charges (continued)	
Other Fees	
Columbarium Plate (not including costs of engraving to Town)	\$77.00
Overtime Rate per hour	\$283.00
Archaeological Dig – per hour (not including ministry charges)	\$93.00
Dedication Items with Plaque (includes engraving)	
Wheel Chair Accessible Picnic Table	\$4,000.00
6-Foot "Pelham Bench"	\$3,000.00
Pride Bench	\$3,000.00
Bike Rack	\$1,000.00
Bike Repair Station	\$4,500.00
Concrete Ping Pong Table	\$10,500.00
Chess/Checkers Games Table	\$4,000.00
Tree Dedication	\$750.00
Permit Fees	
Special Event Permits (includes administration, site inspection and traffic plan review)	\$160.00
Municipal Permit and Inspection Fee	\$160.00



Public Works

	2023
Permit Fees (continued)	
Road Closure/Open Fees	
Closure/Open (4 hours max)	\$244.00
Overtime – Closure/Open (4 hours max)	\$303.00
Double Time Sunday and Holidays – Closure /Open (4 hours max)	\$372.00
Barricade/Cone/Barrel Deposit – refundable	
Under 10 Units	\$106.00
10 – 20 Units	\$212.00
Over 20 Units	\$530.00
Unsolicited Request to Purchase Lands Due Diligence Fee	\$1,273.00
Municipal Property Damage	Full Cost Recovery
Development Inspection per diem	Full Cost Recovery
Closed Road Allowance Disposal Charges	Full Cost Recovery
Special Customized Signage	Full Cost Recovery

**Inquiries related to this user fee and charges guide
and requests for alternate formats can be directed to:**

The Corporation of the Town of Pelham
Attention: Corporate Services Department
Town of Pelham, Municipal Building
P.O Box 400, 20 Pelham Town Square
Fonthill, Ontario
L0S 1E0